

ALL CONSTRUCTION TO BE COMPLIANT WITH THE 'CITY OF CONCORD 2005 CONSTRUCTION STANDARDS AND DETAILS' ADOPTED 4/6/05

INSTALL 2-STEEL ARCHES AT PLEASANT AND WARREN STREETS WITH FIBEROPTIC LIGHTING BY DUMONT DESIGN OR EQUAL

PRESERVE AND PROTECT EXIST. TREES DURING CONSTRUCTION ACTIVITIES (TYP)

6'x24" W x 18" H GRANITE BENCHES (1 TOTAL) BY SWENSON GRANITE OF EQUAL. SET ON EXISTING PAVED GRADE

INSTALL STEEL BECH WITH FIBEROPTIC LIGHTING OPTION - SEE UTILITY PLAN SHEET A

5'-5 1/2" x 8" BLACK PLASTIC PLANTERS BY SHARON POTTER OF EQUAL. PLANT EACH WITH UPRIGHT EVERGREEN - JW (TYP)

MEPPIMACK FINE INTERPRETIVE SIGNAGE SIGN BY METAL PHOTO OR EQUAL. AFFIX TO MARGARITA BUILDING AT EYE LEVEL

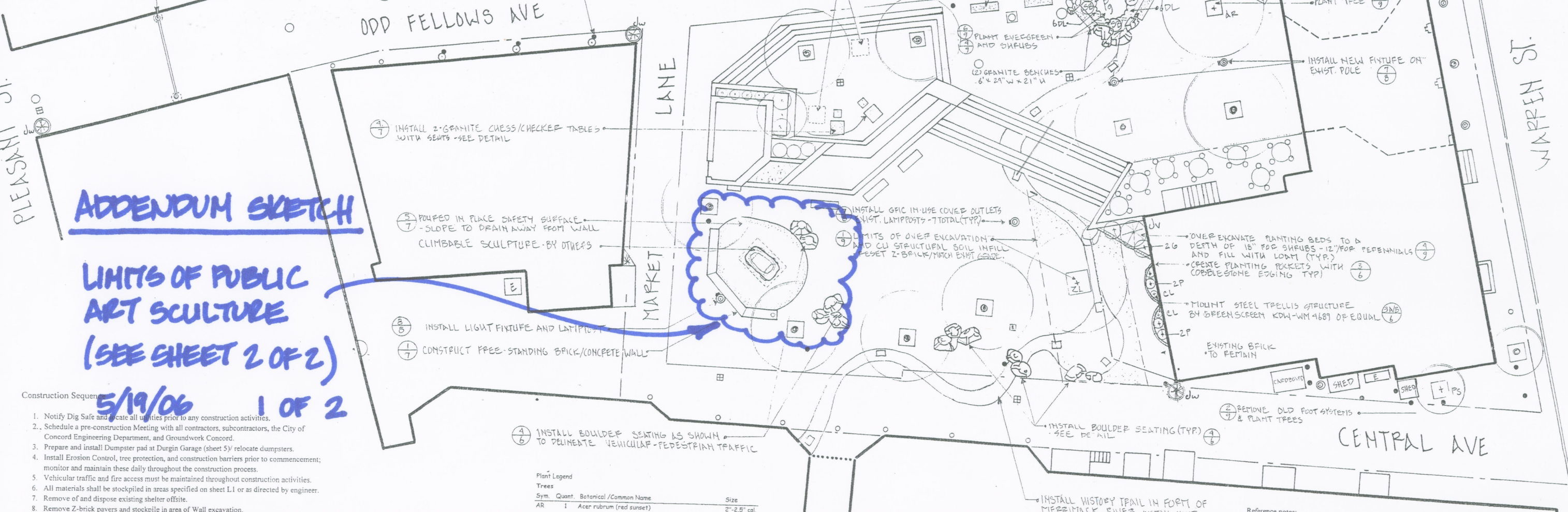

**ADDENDUM SKETCH**

**LIMITS OF PUBLIC ART SCULPTURE (SEE SHEET 2 OF 2)**

Construction Sequence **5/19/06** 1 OF 2

1. Notify Dig Safe and locate all utilities prior to any construction activities.
2. Schedule a pre-construction Meeting with all contractors, subcontractors, the City of Concord Engineering Department, and Groundwork Concord.
3. Prepare and install Dumpster pad at Durgin Garage (sheet 5) relocate dumpsters.
4. Install Erosion Control, tree protection, and construction barriers prior to commencement; monitor and maintain these daily throughout the construction process.
5. Vehicular traffic and fire access must be maintained throughout construction activities.
6. All materials shall be stockpiled in areas specified on sheet L1 or as directed by engineer.
7. Remove of and dispose existing shelter offsite.
8. Remove Z-brick pavers and stockpile in area of Wall excavation.
9. Excavate and pour wall footings, install electric conduit and light/arch footings.
10. Form /pour monolith for wall and install drainage for sculpture base.
11. Inspect electrical and drainage connections prior to backfilling.
12. Install Margaritas improvements: trellis, cobbles and prep beds.
13. Install raised planter bed, stone benches and chess boards and seating.
14. Layout and install upper portion of history trail along Odd Fellows Ave.
15. Backfill foundations and install footing for sculpture and prep base for concrete pad prior to brick wall construction. Set boulders on edge.
16. Inspect samples of CU soil according to manufacturer's specifications.
17. Excavate for structural soil pockets and install Electrical conduit and drainage pipe.
18. Install CU structural soil and compact to specifications.
19. Layout history trail, prepare base and reset Z-brick in area outside trail.
20. Relocate construction barriers and remove remaining brick in public right of way.
21. Set History trail, cut in adjoining z-brick and compact in place.
22. Set remaining boulders and reset remaining Z-brick.
23. Prepare planting beds with loam; provide soil samples prior to material delivery.
24. Install trees, other vegetation and apply 3" nominal thickness mulch.
25. Install MH lighting, GFI outlets, holiday lighting, and steel arches.
26. Inspect safety surface samples and install according to manufacturers specifications.
27. Pressure wash entire area of disturbance after mobilizing all construction equipment.
28. Contact City of Concord Engineering Department to sign off on installation.
29. Sculpture to be set at finish of project.
30. Any questions can be directed to Ed Roberge City of Concord Community Development 225-8520 or John Sullivan Groundwork Concord 224-3170.

INSTALL BOULDER SEATING AS SHOWN TO DELINEATE VEHICULAR-PEDESTRIAN TRAFFIC

Plant Legend			
Trees			
Sym.	Quant.	Botanical /Common Name	Size
AR	1	Acer rubrum (red sunset)	2"-2.5" cal.
PS	1	Prunus sargentii colummaris (cherry)	2.5"-3" cal.
ZL	1	Zelcova 'green vase' (zelcova)	2.5"-3" cal.
PG	1	Picea orientalis 'gowdy' or baker blue (spruce)	7-8 BB
understory			
Sym.	Quant.	Botanical /Common Name	Size
DL	24	Hemerocallis happy returns, big time happy or rosey returns (daylilies)	1 gal
SB	4	Carefree beauty or delight (shrub rose)	#2
Jw	5	Juniperus witchita blue (upright juniper)	5'-6' BB
Margaritas Planting			
Sym.	Quant.	Common/ Botanical Name	Size
Jv	1	Juniperus spartan (Juniper)	7'-8' BB
G	2	Panicum v. Shonandah switchgrass (grass)	#3
P	4	Perivaska Longin or atriplicifolia (russian sage)	#2
CI	2	Clematis (choose 2) Dutchess of edinberg, pink champagne or Jackmanni (clematis)	#3

All plants referenced from Milican's catalog : Chichester, NH (435-6660)

OVER EXCAVATE PLANTING BEDS TO A DEPTH OF 18" FOR SHRUBS - 12" FOR PERENNIALS AND FILL WITH LOAM (TYP) CREATE PLANTING POCKETS WITH COBBLESTONE EDGING TYP

MOUNT STEEL TRELIS STRUCTURE CL BY GREEN SCREEN KDW-WM 4689 OF EQUAL

EXISTING BRICK TO REMAIN

REMOVE OLD FOOT SYSTEMS & PLANT TREES

INSTALL HISTORY TRAIL IN FORM OF MEPPIMACK PINE. INSTALL UNIT PAVERS AND 12 GRANITE HISTORY TILES

- Reference notes:
1. The information shown hereon was taken from an as-built plan of "Bicentennial Square", scale: 1"=10', dated 1977, prepared by the City of Concord Engineering Division.
  2. Additional information was derived from a plan entitled "Bicentennial Square", scale 1"=30', prepared by City of Concord Planning Department in 2003 and on ground field investigation and measurement.

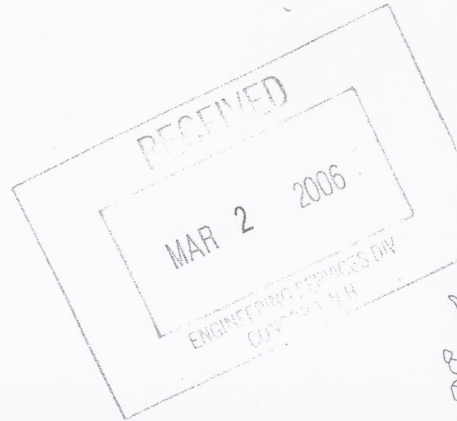

# BICENTENNIAL SQUARE LANDSCAPE PLAN

CITY OF CONCORD NEW HAMPSHIRE



SCALE: 1" = 10'  
SHEET 2 OF 9  
OCTOBER 2005  
REVISED: NOVEMBER, 2005 (NOTES)  
JANUARY, 2006 (SCULPTURE)